

EN General installation guidelines

The fireplace can be mounted to any type of ceiling, as long as the ceiling can carry the weight of the fireplace.

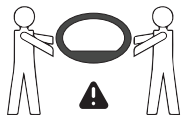

The fireplace should be installed with a safety distance of minimum 1 meter to flammable materials.



Installing the Floh ceiling mounted bioethanol fireplace is recommended to be a two person job.

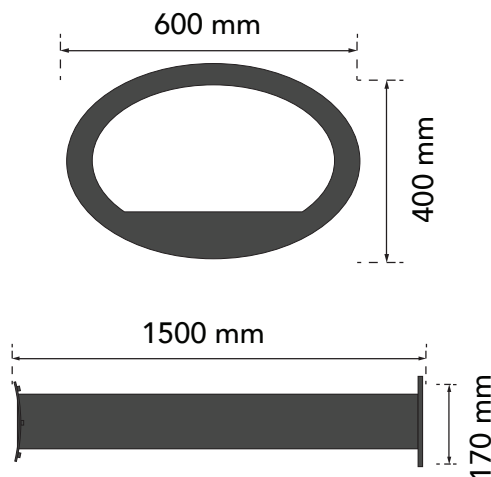

1

Attach the deco pipe to the ceiling, using 4 appropriate screws and plugs, which are compatible with your ceiling.

Tip:

Mark the 4 holes on the ceiling with a pencil.

Then drill 4 holes with a drill and use a plug. Then hang the fake chimney from the ceiling.

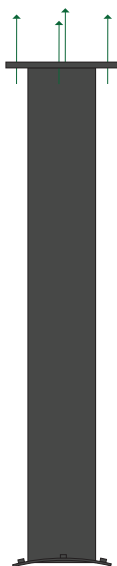

2

When the pipe is attached to the ceiling, attach the fireplace to the deco pipe, using the 4 supplied screws.

Attention:

Tighten the screws simultaneously, making sure that the screws are not fully tightened and that you do this evenly without breaking the thread.

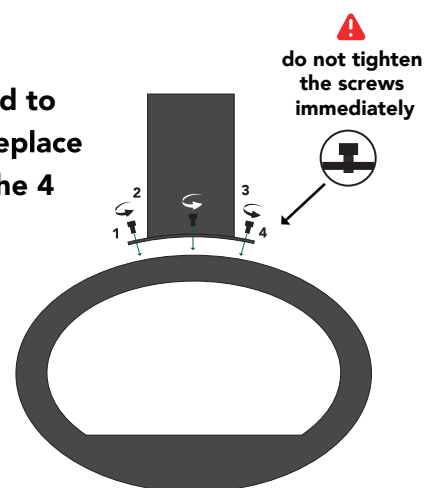

Be careful and proceed with caution

On recessed ceilings with plasterboard or similar plates, the fireplace should preferably be attached to one of the overhead joists behind the ceiling plates to ensure that the ceiling can support the weight of the fireplace.

3

After hanging it securely, we recommend checking whether the pipe hangs straight and firmly. After checking, you can place the burner in the fireplace.



Attention:

Before using the burner, we recommend reading the burner manual.

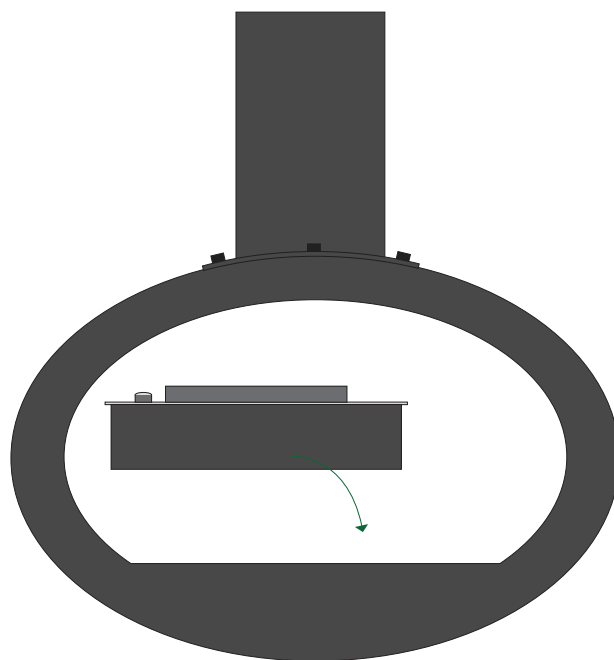

CLEAN FIRE SYSTEM

XARALYN®